

williams&works

engineers | surveyors | planners

March 8, 2024

Craig Stolsonburg
Village Manager
100 East Main Street
Middleville MI 49333

**Village of Middleville
High Street Reconstruction
ADDENDUM NO. 1**

Notice to All Prospective Bidders

This Addendum is issued in accordance with SECTION 00 20 00 - INSTRUCTIONS TO BIDDERS, and is hereby incorporated into the Contract Documents. The CONTRACTOR is reminded to acknowledge receipt of this Addendum in SECTION 00 42 00 - PROPOSAL.

Modifications to Specifications:

1. Section 00 41 00 - Bid Form (Re-issued)
 - Add Item 58 "Sanitary Sewer, Heavy Clean & Televis, 10 inch"
 - Add Item 60 "Cured In-Place Pipe Liner, 10 inch"
 - Revise Item 57 quantity to 235 Ft
 - Revise Item 59 quantity to 235 Ft
2. Section 01 20 00 - Measurement and Payment (Re-issued)
 - Add Item 58 "Sanitary Sewer, Heavy Clean & Televis, 10 inch"
 - Add Item 60 "Cured In-Place Pipe Liner, 10 inch"

Modifications to Drawings:

1. Sheet 14: (Re-issued) Updated lining pattern to exclude manholes
2. Sheet 15: (Re-issued) Updated lining pattern limits to reflect updated quantities
3. Sheet 16: (Re-issued) Updated lining pattern limits to reflect updated quantities

Respectfully submitted,

Williams & Works

David Mickevich, EIT

Enclosures: Section 00 41 00 Bid Form
Section 01 20 00 Measurement and Payment
Plan Sheet 14 – CONSTRUCTION: STA 10+50 TO STA 14+50
Plan Sheet 15 – CONSTRUCTION: STA 14+50 TO STA 18+50
Plan Sheet 16 – CONSTRUCTION: STA 18+50 TO STA 22+50

cc: Plan holders of Record
Alec Belson – Village of Middleville
Brandon Mieras, PE – Williams & Works

VILLAGE OF MIDDLEVILLE
HIGH STREET RECONSTRUCTIONARTICLE 1-SCHEDULE OF PRICES

For the entire Work outlined in these Contract Documents complete as specified, using equipment and materials only of the type and manufacturers where specifically named, for the following unit and lump sum prices:

<u>Unit No.</u>	<u>Description</u>	<u>Unit</u>	<u>Qty</u>	<u>Unit Price</u>	<u>Total Price</u>
1	General Conditions, Bonds, Insurance, Max 5%	Lsum	0.33	\$_____	\$_____
2	Mobilization, Max 10%	Lsum	0.67	\$_____	\$_____
3	Curb and Gutter, Rem	Ft	2950	\$_____	\$_____
4	Sidewalk, Rem	Syd	1065	\$_____	\$_____
5	Pavt, Rem, Modified	Syd	6110	\$_____	\$_____
6	Sewer, Rem, Less than 24 inch	Ft	142	\$_____	\$_____
7	Plug, 12 inch Storm Penetration	Ea	2	\$_____	\$_____
8	Machine Grading, Road	Sta	18	\$_____	\$_____
9	Machine Grading, Sidewalk	Sta	18	\$_____	\$_____
10	Erosion Control, Inlet Protection, Fabric Drop	Ea	11	\$_____	\$_____
11	Erosion Control, Silt Fence	Ft	1000	\$_____	\$_____
12	Subbase, CIP	Cyd	2290	\$_____	\$_____
13	Aggregate Base, 8 inch	Syd	6310	\$_____	\$_____
14	Dr Structure Cover, Adj, Case 1	Ea	16	\$_____	\$_____
15	Dr Structure Cover, Type B	Ea	8	\$_____	\$_____
16	Dr Structure Cover, Type K	Ea	6	\$_____	\$_____
17	Dr Structure, 48 inch Dia	Ea	2	\$_____	\$_____
18	Storm Sewer, C76 CI III, 12 inch	Ft	90	\$_____	\$_____
19	HMA, 3EL	Ton	764	\$_____	\$_____
20	HMA, 5EL	Ton	764	\$_____	\$_____
21	Driveway, Nonreinf Conc, 6 inch	Syd	440	\$_____	\$_____

SECTION 00 41 00ADDENDUM NO. 1 - 00 41 00.2
BID FORM

22	Curb and Gutter, Conc, Det F4	Ft	3635	\$ _____	\$ _____
23	Valley Gutter, Conc	Ft	70	\$ _____	\$ _____
24	Detectable Warning Surface	Ft	68	\$ _____	\$ _____
25	Sidewalk, Conc, 4 inch	Sft	15030	\$ _____	\$ _____
26	Curb Ramp, Conc, 6 inch	Sft	1280	\$ _____	\$ _____
27	Mailbox, Relocate	Ea	18	\$ _____	\$ _____
28	Minor Traf Devices	Lsum	1	\$ _____	\$ _____
29	Traf Regulator Control	Lsum	1	\$ _____	\$ _____
30	Slope Restoration, Non-Freeway, Type B	Syd	2406	\$ _____	\$ _____
31	Hydrant, Rem	Ea	2	\$ _____	\$ _____
32	Valve and Box, Rem	Ea	1	\$ _____	\$ _____
33	Gate Box, Adj, Temp, Case 1	Ea	2	\$ _____	\$ _____
34	Water Main, 8 inch	Ft	1830	\$ _____	\$ _____
35	Water Service, Copper, 1 inch (Main to Curb Box)	Ft	630	\$ _____	\$ _____
36	Water Service, Copper, 1 inch (Curb Box to Meter), Allowance	Ft	450	\$ _____	\$ _____
37	Plumbing Allowance for Lead Service Replacement	Lsum	1	\$ _____	\$ _____
38	Water Main, 6 inch	Ft	22	\$ _____	\$ _____
39	Curb Stop and Box on Water Service, 1 inch	Ea	15	\$ _____	\$ _____
40	Valve and Box, 8 inch	Ea	13	\$ _____	\$ _____
41	Reconnect Existing 1 inch Water Service	Ea	15	\$ _____	\$ _____
42	Connect to Ex. 8 Water Main, Main St.	Ea	1	\$ _____	\$ _____
43	Connect to Ex. 6 Water Main, Alley	Ea	1	\$ _____	\$ _____
44	Connect to Ex. 4 Water Main, Dibble & Dayton	Ea	2	\$ _____	\$ _____
45	Connect to Ex. 6 Water Main, Railroad	Ea	1	\$ _____	\$ _____
46	Connect to Ex. 6 Water Main, Fremont	Ea	1	\$ _____	\$ _____

SECTION 00 41 00ADDENDUM NO. 1 - 00 41 00.3
BID FORM

47	Tee, 8 inch x 8 inch x 8 inch	Ea	4	\$ _____	\$ _____
48	Tee, 8 inch x 8 inch x 6 inch	Ea	6	\$ _____	\$ _____
49	Valve and Box, 6 inch	Ea	1	\$ _____	\$ _____
50	Bend, 45 Degree, 8 inch	Ea	25	\$ _____	\$ _____
51	Bend, 11 Degree, 8 inch	Ea	2	\$ _____	\$ _____
52	Bend, 22 Degree, 8 inch	Ea	1	\$ _____	\$ _____
53	Reducer, 8 inch x 6 inch	Ea	2	\$ _____	\$ _____
54	Reducer, 8 inch x 4 inch	Ea	2	\$ _____	\$ _____
55	Hydrant Assembly	Ea	4	\$ _____	\$ _____
56	Bend, 45 Degree, 6 inch	Ea	2	\$ _____	\$ _____
57	Sanitary Sewer, Heavy Clean & Televiser, 8 inch	Ft	235	\$ _____	\$ _____
58	Sanitary Sewer, Heavy Clean & Televiser, 10 inch	Ft	63	\$ _____	\$ _____
59	Cured In-Place Pipe Liner, 8 inch	Ft	235	\$ _____	\$ _____
60	Cured In-Place Pipe Liner, 10 inch	Ft	63	\$ _____	\$ _____
61	Clearing	Acre	0.14	\$ _____	\$ _____
62	Abandon and Fill Underground Utilities	Ft	2000	\$ _____	\$ _____
63	Pavt Mrkg, Polyurea, 4 inch, White	Ft	175	\$ _____	\$ _____
64	Pavt Mrkg, Polyurea, 4 inch, Yellow	Ft	2915	\$ _____	\$ _____
65	Pavt Mrkg, Polyurea, 6 inch, Crosswalk	Ft	432	\$ _____	\$ _____
66	Pavt Mrkg, Polyurea, 24 inch, Stop Bar	Ft	75	\$ _____	\$ _____
67	Sign, Type IIIA	Sft	126.5	\$ _____	\$ _____
68	Post, Steel, 3 pound	Ft	245	\$ _____	\$ _____
Total Base Bid					\$ _____

ARTICLE 2-MATERIAL AND EQUIPMENT ALTERNATES

The Contract Documents stipulate that the Base Bid price shall include materials and equipment selected from the designated items and manufacturers listed therein. This is done to establish uniformity in bidding and to establish standards of quality for the items named.

If the BIDDER wishes to quote alternate items for consideration by the OWNER, he may do so under this Article. A complete description of the item and the proposed price differential are to be provided. Unless approved at the time of award, substitutions, where items are specifically named, will be considered only in accordance with the terms set forth in the General Conditions.

<u>Item No.</u>	<u>Description</u>	<u>Add/Deduct Amount (Dollars)</u>
-----------------	--------------------	--

ARTICLE 3-TIME ALTERNATE

If the BIDDER takes exception to the time(s) stipulated in Article 3 - Contract Time of the Agreement, he is requested to stipulate below his proposed time for performance of the Work. Consideration will be given to time in evaluating bids.

ARTICLE 4-SUBCONTRACTOR LISTING

Bid is submitted on the basis of the use of the following Subcontractors:

<u>WORK ITEM</u>	<u>FIRM</u>	<u>CITY</u>
_____	_____	_____
_____	_____	_____
_____	_____	_____
_____	_____	_____
_____	_____	_____
_____	_____	_____
_____	_____	_____
_____	_____	_____

Please note if work is to be performed by BIDDER. Failure to list Subcontractors with the Bid waives BIDDER'S rights to a change in Contract Time or Price or withdrawal of Bid and Bid Security; in the event OWNER has reasonable objection to any Subcontractor.

OWNER shall have the right to reject any Subcontractor for reasonable cause. If Subcontractors are not identified in the Bid, the BIDDER/CONTRACTOR shall engage a Subcontractor acceptable to OWNER and waives the right to withdraw Bid and Bid Security, and further, waives right to a change in Contract Time or Price due to failure to list.

PART 1 - GENERAL

1.01 SECTION INCLUDES:

- A. Measurement and payment criteria applicable to the Work.

1.02 AUTHORITY:

- A. Measurement methods delineated in the individual specification sections are intended to complement the criteria of this section.
- B. The ENGINEER will take all measurements and compute quantities accordingly.
- C. Assist by providing necessary equipment, workers, and survey personnel as required.

1.03 UNIT QUANTITIES SPECIFIED:

- A. Quantities and measurements indicated in the Bid Form are for bidding and contract purposes only. Quantities and measurements supplied or placed in the Work and verified by the ENGINEER shall determine payment.
- B. If the actual Work requires more or fewer quantities than those quantities indicated, provide the required quantities at the unit prices contracted.

1.04 MEASUREMENT OF QUANTITIES:

- A. Measurement Devices:
 - 1. Weigh Scales: Inspected, tested and certified.
 - 2. Platform Scales: Of sufficient size and capacity to accommodate the conveying vehicle.
 - 3. Metering Devices: Inspected, tested and certified.
- B. Measurement by Weight: Concrete reinforcing steel, rolled or formed steel or other metal shapes will be measured by handbook weights. Welded assemblies will be measured by handbook weights.
- C. Measurement by Volume: Measured by cubic dimension using mean length, width and height or thickness.
- D. Measurement by Area: Measured by square dimension using mean length and width or radius.
- E. Linear Measurement: Measured by linear dimension, at the item centerline.

1.05 PAYMENT:

- A. Payment Includes: Full compensation for all required labor, products, tools, equipment, plant, transportation, services and incidentals; erection, application or installation of an item of the Work; overhead and profit.
- B. Final payment for Work governed by unit prices will be made on the basis of the actual measurements and quantities accepted by the ENGINEER multiplied by the unit price for Work which is incorporated in or made necessary by the Work.

1.06 MEASUREMENT AND PAYMENT SCHEDULE:

- A. The following schedule outlines the method of measurement and basis of payment to be used on this project. Requirements for materials and methods described under each unit price are included in the specification sections.
1. **General Conditions, Bonds, Insurance, Max 5%:** Paid as a lump sum. Payment will be made once 5% of the contract work has been completed.

2. **Mobilization, Max 10%:** Paid as a lump sum. Payment will be based on the following payment schedule: 50% of bid amount for 5% of original contract amount completed; 75% of bid amount for 10% of original contract amount completed; 100% of bid amount for 25% of original contract amount completed.
3. **Curb and Gutter, Rem:** Will be measured by the linear foot along the base of the curb face or along the flowline of the gutter where marked by the Engineer, regardless of vertical size. Includes saw cutting.
4. **Sidewalk, Rem:** Measured and paid for by the square yard, regardless of depth. Payment includes all driveways and sidewalks. All removals shall be to a saw cut edge at an existing sidewalk joint.
5. **Pavt, Rem, Modified:** Measured and paid for by the square yard, regardless of depth. Payment includes all improved street surfaces, driveways and sidewalks, regardless of material, where improved surfaces are called for removal. Gravel surfaces are excluded. All removals shall be to a saw cut edge.
6. **Sewer, Rem, Less than 24 inch:** Includes all necessary excavation, cutting of existing sewer, and removal. Payment will be at the contract unit price per linear foot and will include all labor, tools, equipment, material, excavation, and backfill required to remove the existing sanitary sewer or plugs and flowable fill for the main being taken out of service if main can remain in place as approved by the Engineer. Payment will include the placement of masonry plug at the removal limits as directed by the Engineer. Removals necessary for the construction of the sanitary sewer systems and not specifically called out on the plans will be considered incidental to construction.
7. **Plug, 12 inch Storm Penetration:** Paid for by each brick and mortar plug installed on existing storm manholes. Includes all labor, materials, and equipment.
8. **Machine Grading, Road:** Measured along street centerline and paid for by the 100 foot station. This item shall include rough grading, shaping, fine grading, removal of culverts, earth excavation, embankment, and all earthwork necessary to construct the proposed street section from right-of-way line to right-of-way line. Includes any necessary clearing and grubbing including removal and disposal of all brush and vegetation less than 6" in diameter regardless of species.
9. **Machine Grading, Sidewalk:** Measured along sidewalk centerline and paid for by the 100 foot station. This item shall include rough grading, shaping, fine grading, removal of culverts, earth excavation, embankment, and all earthwork necessary to construct the proposed sidewalk section from right-of-way line to right-of-way line. Includes any necessary clearing and grubbing including removal and disposal of all brush and vegetation less than 6" in diameter regardless of species.
10. **Erosion Control, Inlet Protection, Fabric Drop:** Paid for by each fabric drop used. All existing catch basin inlets within the construction influence area shall receive inlet protection.
11. **Erosion Control, Silt Fence:** Will be measured by the linear foot along the line of silt fence placed. Place silt fence where specified on plans.
12. **Subbase, CIP:** Calculated from the proposed street section and paid for by the cubic yard compacted in place where used and authorized by the ENGINEER. Where existing soils area adequate for subbase (determined by Engineer), payment for subbase will not be made.
13. **Aggregate Base, 8 inch:** Measured and paid for by the square yard for the thickness and MDOT specified material, compacted in place, tested and accepted.
14. **Dr Structure Cover, Adj, Case 1:** Paid for each structure adjusted to match proposed grade.
15. **Dr Structure Cover, Type B:** Paid for by each casting placed. Replace castings as noted on plans. Castings placed with new drainage structures will not be paid for separately.
16. **Dr Structure Cover, Type K:** Replace castings as noted on plans. Castings placed with new drainage structures will not be paid for separately.
17. **Dr Structure, 48 inch Dia:** Counted and paid for by the unit as shown in the Bid Form and includes furnishing and installing the structure, grade rings, casting, covers and all other accessories as specified and detailed. Furnishing, adjusting and finishing of castings on new storm manholes, is considered included in the cost of the storm manhole, and shall not be paid for separately.
18. **Storm Sewer, C76 CI III, 12 inch:** Measured horizontally on the surface along the pipe centerline from center to center of manholes and paid for the linear foot by the pipe size including: excavation, bedding, backfill, compaction, and all related work.
19. **HMA, 3EL:** Paid for by the ton for the mix specified, compacted and accepted. Measured by tallying load tickets. Submit all load tickets to ENGINEER at time of delivery. Estimated quantities based on 110#/syd/inch.
20. **HMA, 5EL:** Paid for by the ton for the mix specified, compacted and accepted. Measured by tallying load tickets. Submit all load tickets to ENGINEER at time of delivery. Estimated quantities based on 110#/yd2/inch.
21. **Driveway, Nonreinf Conc, 6 inch:** Measured and paid for by the square foot for the depth specified for concrete drives poured in place according to the specifications, plan details and notes. Includes all form work, materials, labor, and equipment to perform the work.

22. **Curb and Gutter, Conc, Det F4:** Will be measured in place by length in linear feet, along the joint of the curbing with the pavement, with not deduct in length for catch basins, inlet castings, or dub-down drive approaches.
23. **Valley Gutter, Conc:** Will be measured in place by length in linear feet, along the gutter line of the curbing with the pavement.
24. **Detectable Warning Surface:** Measured and apid for by the linear foot. All materials shall be on the MDOT approved manufactures list.
25. **Sidewalk, Conc, 4 inch:** Measured in place by the area placed and paid for by the square foot including: shaping and compacting base; placing form work; placing and finishing concrete; placing expansion joints; providing and placing curing compound.
26. **Curb Ramp, Conc, 6 inch:** Measured in place by the area placed and paid for by the square foot including: shaping and compacting base; placing form work; placing and finishing concrete; placing expansion joints; providing and placing curing compound.
27. **Mailbox, Relocate:** Measured and paid for by each mailbox relocated as specified on plans.
28. **Minor Traf Devices:** Will be measured and paid as a lump sum and includeds all necessary signing, flagging, traffic regulators, drums, and barricades to safely maintain traffic and protect the work site during the duration of the project per the requirements provided in the plans and specifications.
29. **Traf Regulator Control:** Paid as a lump sum. Payment will be based on the following payment schedule: 50% of bid amount for 5% of original contract amount completed; 75% of bid amount for 50% of original contract amount completed; 90% of bid amount for 90% of original contract amount completed; 100% of bid amount for 100% of original contract amount completed.
30. **Slope Restoration, Non-Freeway, Type B:** Measured by the area placed and paid for the square yard including: labor, equipment, and materials to place topsoil surface; fertilizer, chemical nutrient, Class A; seeding mixture; and mulch Blanket which will not be paid for separately but is included in the unit price.
31. **Hydrant, Rem:** Paid for by each hydrant assembly removed as shown on plans.
32. **Valve and Box, Rem:** Paid for by each valve and box removed as shown on plans.
33. **Gate Box, Adj, Temp, Case 1:** Paid for each structure adjusted to match proposed grade.
34. **Water Main, 8 inch:** Measured and paid for by the linear foot of watermain placed from center of fitting to center of fitting. Includes laying pipe of the specified material and class at the grade shown on the plans, backfilling, compaction, and restoration to existing grade as shown on the plans.
35. **Water Service, Copper, 1 inch (Main to Curb Box):** Measured along the pipe centerline at the surface and paid for by the linear foot installed or replaced of the size and material specified, from the corporation to the ROW. Includes pipe, fittings, connections to the corporation stop, curb stop and existing water service, excavation, backfilling, compaction, and restoration to existing grade. Includes abandonment/removal of existing service to ROW line from abandoned watermain.
36. **Water Service, Copper, 1 inch (Curb Box to Meter), Allowance:** Measured along the pipe centerline at the surface and paid for by the linear foot installed or replaced of the size and material specified, from the corporation to the ROW. Includes pipe, fittings, connections to the corporation stop, curb stop and existing water service, excavation, backfilling, compaction, and restoration to existing grade. Includes abandonment/removal of existing service to ROW line from abandoned watermain.
37. **Plumbing Allowance for Lead Service Replacement:** There are suspected lead/galvanized water services on this block. This was an allowance established to pay for all materials, labor, and equipment, including the services of a licensed plumber, required to:

Replace the water service inside and within 3 feet of a building and connected the service to the new water service line placed from the new Water Meter Chamber. Restoration of al slope and landscaping disturbances, and coordination with the resident to complete the work.

Assist property owner and building maintenance staff during water service interruptions. This may be caused during the installation of a new water main and may result in the accumulation of sediment in screens of faucets and private plumbing lines. This work may include shutting off service within a building to prevent draining of the internal water distribution system, cleaning of internal plumbing systems and screens, meeting attendance and other work as approved by the Engineer.

38. **Water Main, 6 inch:** Measured and paid for by the linear foot of watermain placed from center of fitting to center of fitting. Includes laying pipe of the specified material and class at the grade shown on the plans, backfilling, compaction, and restoration to existing grade as shown on the plans.
39. **Curb Stop and Box on Water Service, 1 inch:** Measured and paid for by the unit for each valve and valve box of the size specified installed, backfilled, tested, and accepted.
40. **Valve and Box, 8 inch:** Paid for each provided and installed, including restrained fittings, gaskets, bolts and nuts, and any adjustment needed.

41. **Reconnect Existing 1 inch Water Service:** Shall be measured in units as shown on the Bid Form and includes furnishing all labor and materials necessary to connect an existing copper water service at the right-of-way line.
42. **Connect to Ex. 8 Water Main, Main St.:** Counted and paid for each connection made to an existing watermain. Includes all fittings, materials, equipment, and labor needed to complete the work. Excludes valves and boxes, which are paid separately.
43. **Connect to Ex. 6 Water Main, Alley:** Counted and paid for each connection made to an existing watermain. Includes all fittings, materials, equipment, and labor needed to complete the work. Excludes valves and boxes, which are paid separately.
44. **Connect to Ex. 4 Water Main, Dibble & Dayton:** Counted and paid for each connection made to an existing watermain. Includes all fittings, materials, equipment, and labor needed to complete the work. Excludes valves and boxes, which are paid separately.
45. **Connect to Ex. 6 Water Main, Railroad:** Counted and paid for each connection made to an existing watermain. Includes all fittings, materials, equipment, and labor needed to complete the work. Excludes valves and boxes, which are paid separately.
46. **Connect to Ex. 6 Water Main, Fremont:** Counted and paid for each connection made to an existing watermain. Includes all fittings, materials, equipment, and labor needed to complete the work. Excludes valves and boxes, which are paid separately.
47. **Tee, 8 inch x 8 inch x 8 inch:** Paid for each provided and installed, including restrained fittings, gaskets, bolts and nuts.
48. **Tee, 8 inch x 8 inch x 6 inch:** Paid for each provided and installed, including restrained fittings, gaskets, bolts and nuts.
49. **Valve and Box, 6 inch:** Paid for each provided and installed, including restrained fittings, gaskets, bolts and nuts, and any adjustment needed.
50. **Bend, 45 Degree, 8 inch:** Paid for each provided and installed, including restrained fittings, gaskets, bolts and nuts, and any adjustment needed.
51. **Bend, 11 Degree, 8 inch:** Paid for each provided and installed, including restrained fittings, gaskets, bolts and nuts, and any adjustment needed.
52. **Bend, 22 Degree, 8 inch:** Paid for each provided and installed, including restrained fittings, gaskets, bolts and nuts, and any adjustment needed.
53. **Reducer, 8 inch x 6 inch:** Paid for each provided and installed, including restrained fittings, gaskets, bolts and nuts, and any adjustment needed.
54. **Reducer, 8 inch x 4 inch:** Paid for each provided and installed, including restrained fittings, gaskets, bolts and nuts, and any adjustment needed.
55. **Hydrant Assembly:** Includes the cost of providing and installing the hydrant, hydrant valve, valve box, and all pieces between the water main and hydrant, including the tee, coarse gravel and concrete base, fire hydrant marker at the locations shown on the plans in a ready-for-use condition unless noted otherwise.
56. **Bend, 45 Degree, 6 inch:** Paid for each provided and installed, including restrained fittings, gaskets, bolts and nuts, and any adjustment needed.
57. **Sanitary Sewer, Heavy Clean & Televis, 8 inch:** Measured horizontally on the surface along the pipe centerline from center to center of manholes and paid for the linear foot by the pipe size including: by-pass pumping, cleaning, pre-CIPP inversion television inspection of the sewer to be lined, removal of all roots and mineral deposits, intruding gaskets/sealing rings and other obstructions.
58. **Sanitary Sewer, Heavy Clean & Televis, 10 inch:** Measured horizontally on the surface along the pipe centerline from center to center of manholes and paid for the linear foot by the pipe size including: by-pass pumping, cleaning, pre-CIPP inversion television inspection of the sewer to be lined, removal of all roots and mineral deposits, intruding gaskets/sealing rings and other obstructions.
59. **Cured In-Place Pipe Liner, 8 inch:** Measured horizontally on the surface along the pipe centerline from center to center of manholes and paid for the linear foot by the pipe size including: bypass pumping, liner installation final television inspection, and all related work.
60. **Cured In-Place Pipe Liner, 10 inch:** Measured horizontally on the surface along the pipe centerline from center to center of manholes and paid for the linear foot by the pipe size including: bypass pumping, liner installation final television inspection, and all related work.
61. **Clearing:** Paid for by each acre cleared or fraction thereof. Shall consist of cutting, removing from the ground, and disposing of trees, stumps, brush, shrubs, and other vegetation occurring within the project site which interfere with excavation, embankment or clear vision, or are otherwise noted on the construction drawings to be removed and includes the preservation from injury or defacement of all vegetation and objects designated to remain.
62. **Abandon and Fill Underground Utilities:** Measured and paid for by the length of original utility. Includes the cost of cutting the existing water main, providing and placing the required plug.

- 63. **Pavt Mrkg, Polyurea, 4 inch, White:** Measured and paid for by the length of the pavement marking, in place, along the centerline.
- 64. **Pavt Mrkg, Polyurea, 4 inch, Yellow:** Measured and paid for by the length of the pavement marking, in place, along the centerline.
- 65. **Pavt Mrkg, Polyurea, 6 inch, Crosswalk:** Measured and paid for by the length of the pavement marking, in place, along the centerline.
- 66. **Pavt Mrkg, Ployurea, 24 inch, Stop Bar:** Measured and paid for by the length of the pavement marking, in place, along the centerline.
- 67. **Sign, Type IIIA:** Measured by the square foot placed. This includes the proper insallation, time, and materials.
- 68. **Post, Steel, 3 pound:** Measured by the foot. Item includes all labor and equipment required for proper installation.

PART 2 - PRODUCTS







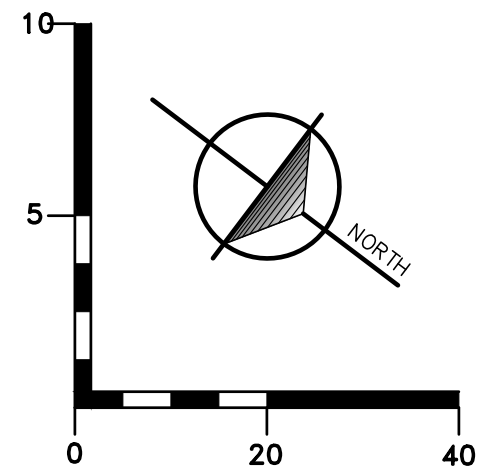
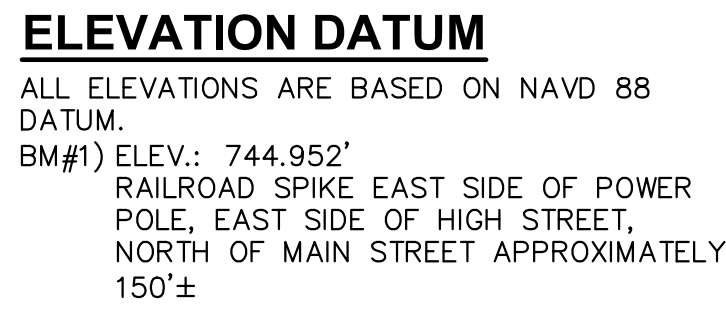



Not used.

PART 3 - EXECUTION

Not used.



PROPOSED ROADWAY LEGEND

	SIDEWALK, CONC, 4 INCH
	SIDEWALK, CONC, 6 INCH
	HMA, 3EML/5EML
	PARKING COUNT
	MDOT F4 CURB & GUTTER
	GUARD RAIL
	SIGN
	UTILITY POLE
	LIGHT POLE
	BARRIER FREE PARKING



THE CONTRACTOR CAUTIONED THAT THE LOCATION AND/OR ELEVATION OF EXISTING UTILITIES AS SHOWN ON THESE PLANS IS BASED ON RECORDS OF THE CITY OF CHICAGO. THE CONTRACTOR HAS CONDUCTED VISUAL SURVEYS IN THE FIELD. THE INFORMATION IS NOT RELIED ON TO BE EXACT OR COMPLETE. FOR PROTECTION OF UNDERGROUND UTILITIES, AND IN CONFORMANCE WITH PUBLIC ACT 53, 1911, CHICAGO, ILLINOIS, THE CONTRACTOR SHALL TOLL, REPAIR OR REMOVE AND/OR REPAIR OR REPLACE ANY EXISTING UTILITIES, EXCLUDING SANITARY, SUNDAYS, AND HOLIDAYS, PRIOR TO BEGINNING EACH EXCAVATION IN AREAS WHERE PUBLIC UTILITIES HAVE NOT BEEN PREVIOUSLY LOCATED. THE CONTRACTOR SHALL BE RESPONSIBLE FOR THE PROTECTION OF ANY UTILITIES NOTIFIED. THIS DOES NOT RELIEVE THE CONTRACTOR FROM NOTIFYING UTILITY OWNERS WHO MAY NOT BE A PART OF THE "MISS DIG" SYSTEM. IT SHALL BE THE CONTRACTOR'S RESPONSIBILITY TO OBTAIN ANY NECESSARY PERMITS, WHICH CONFLICT WITH THE PROPOSED IMPROVEMENTS SHOWN ON THE PLANS.



NO.	ISSUED FOR	BY	DATE
1.	OWNER REVIEW	DM	9/15/23
2.	PERMITTING	DM	1/18/24
3.	CONTRACTOR BID	DM	2/27/24
4.	ADDENDUM NO. 1	DM	3/8/24

**VILLAGE OF MIDDLEVILLE
BARRY COUNTY, MI
HIGH STREET RECONSTRUCTION**

CONSTRUCTION: STA 10+50 TO STA 14+50

DESIGNED BY D MICKEVICH	DATE 12/23
DRAWN BY O CROSBY	DATE 12/23
CHECKED BY B MIERAS	DATE 2/26/24
PROJECT 222158	
FILE PIT-CONST.dwg	
<div style="text-align: center;"> 14 SHEET NO. </div>	

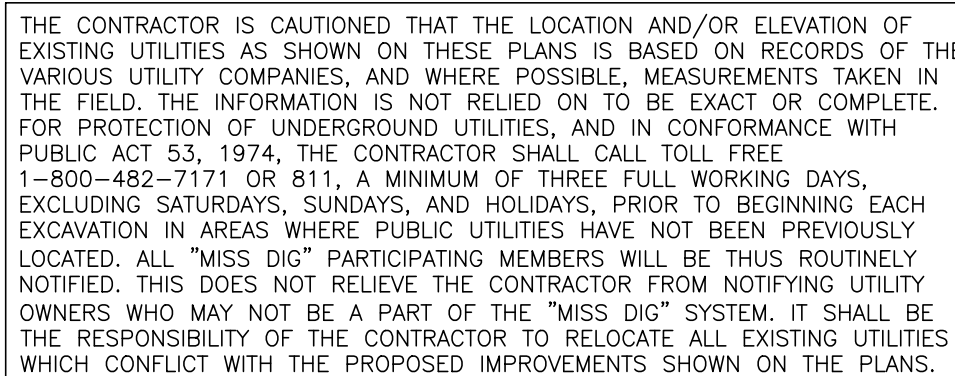
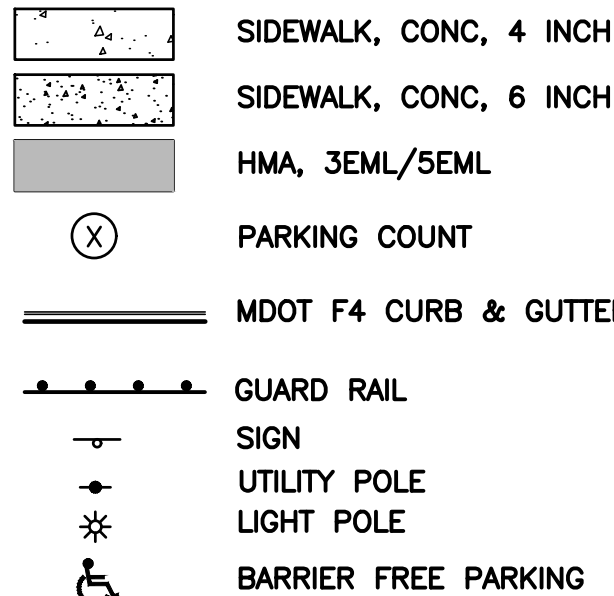

Mar 08, 2024 - 3:45pm P:\Projects\222158-Middleville-High-St\222158CVH-CONST.dwg, xREF: [wp] [bwp] [222158B-ENG]
BY: MCKICKE

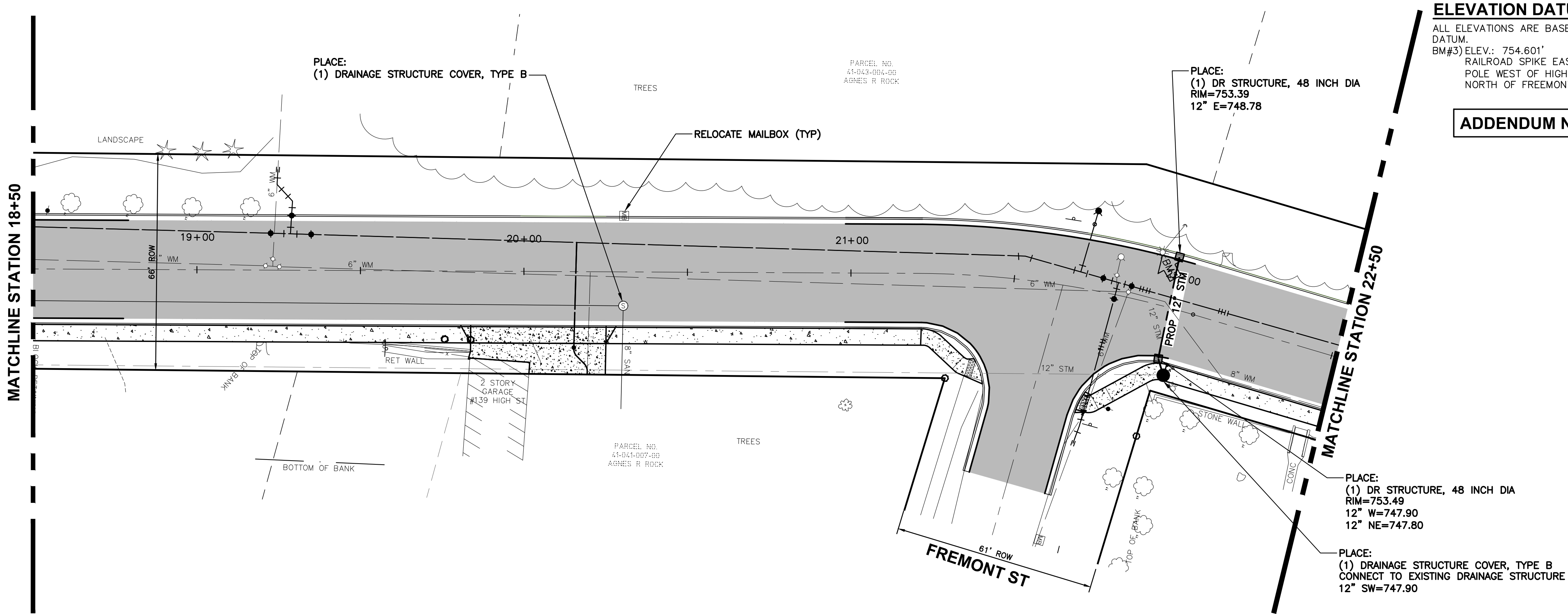

ELEVATION DATUM

ALL ELEVATIONS ARE BASED ON NAVD 88 DATUM.
BM#3) ELEV.: 754.601'
RAILROAD SPIKE EAST SIDE OF LIGHT POLE WEST OF HIGH STREET, 10'± NORTH OF FREEMONT STREET

ADDENDUM NO. 1

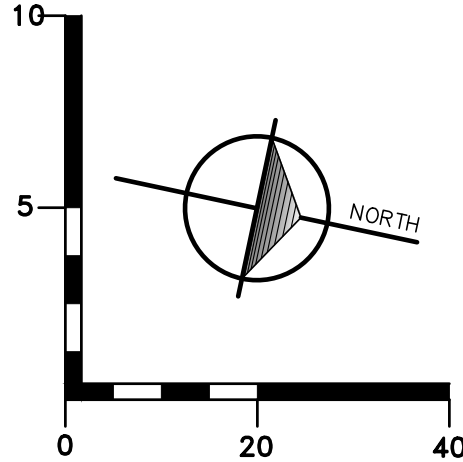

PROPOSED ROADWAY LEGEND

- SIDEWALK, CONC, 4 INCH
- SIDEWALK, CONC, 6 INCH
- HMA, 3EML/5EML
- PARKING COUNT
- MDOT F4 CURB & GUTTER
- GUARD RAIL
- SIGN
- UTILITY POLE
- LIGHT POLE
- BARRIER FREE PARKING

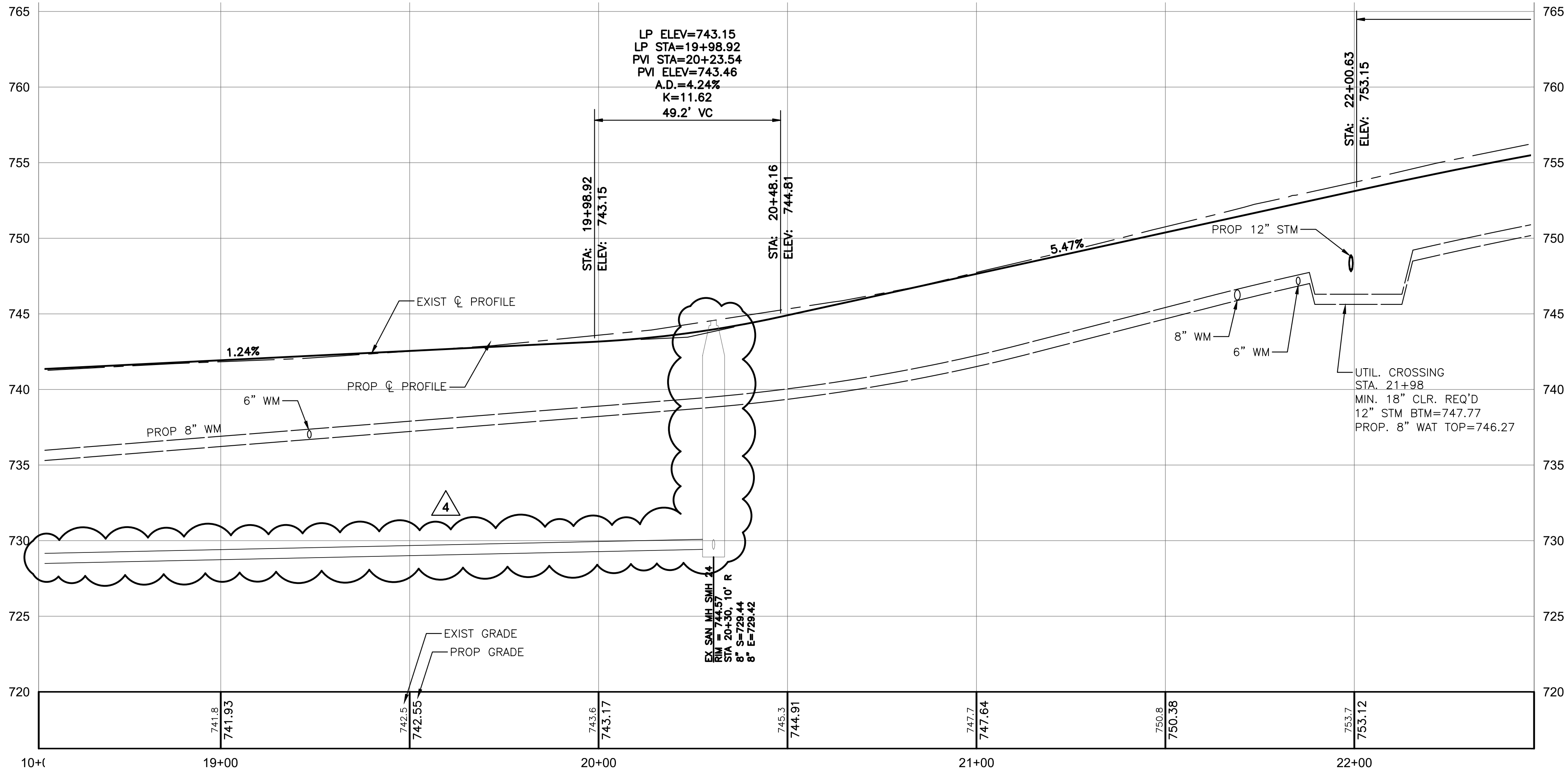

THE CONTRACTOR IS CAUTIONED THAT THE LOCATION AND/OR ELEVATION OF EXISTING UTILITIES AS SHOWN ON THESE PLANS IS BASED ON RECORDS OF THE VARIOUS UTILITY COMPANIES, AND WHERE POSSIBLE, MEASUREMENTS TAKEN IN THE FIELD. THE INFORMATION IS NOT RELIED ON TO BE EXACT OR COMPLETE. FOR PROTECTION OF UNDERGROUND UTILITIES, AND IN CONFORMANCE WITH PUBLIC ACT 53, 1974, THE CONTRACTOR SHALL CALL TOLL FREE 1-800-482-7171 OR 811, A MINIMUM OF THREE FULL WORKING DAYS, EXCLUDING SATURDAYS, SUNDAYS, AND HOLIDAYS, PRIOR TO BEGINNING EACH EXCAVATION IN AREAS WHERE PUBLIC UTILITIES HAVE NOT BEEN PREVIOUSLY LOCATED. ALL "MISS DIG" PARTICIPATING MEMBERS WILL BE THUS ROUTINELY NOTIFIED. THIS DOES NOT RELIEVE THE CONTRACTOR FROM NOTIFYING UTILITY OWNERS WHO MAY NOT BE A PART OF THE "MISS DIG" SYSTEM. IT SHALL BE THE RESPONSIBILITY OF THE CONTRACTOR TO RELOCATE ALL EXISTING UTILITIES WHICH CONFLICT WITH THE PROPOSED IMPROVEMENTS SHOWN ON THE PLANS.



williams&works
engineers surveyors planners
616.224.1500 phone
http://williamsworks.com
549 Ottawa Ave NW
Grand Rapids, MI 49503

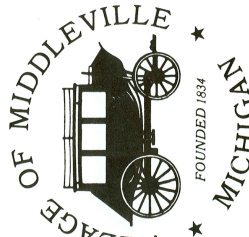

NO.	ISSUED FOR	BY	DATE
1.	OWNER REVIEW	DM	9/15/23
2.	PERMITTING	DM	1/18/24
3.	CONTRACTOR BID	DM	2/27/24
4.	ADDENDUM NO. 1	DM	3/8/24

VILLAGE OF MIDDLEVILLE
BARRY COUNTY, MI
HIGH STREET RECONSTRUCTION

CONSTRUCTION: STA 18+50 TO STA 22+50

DESIGNED BY	DATE	DRAWN BY	DATE	CHECKED BY	DATE
D. MCKEIVICH	12/23	O. CROSBY	12/23	B. MIERAS	2/26/24
PROJECT	222158	FILE	Pit-CONST.dwg		

16

SHEET NO.